

NOTICE!!

These documents have been scanned!

Do not place un-scanned documents beneath this notice!

Do not remove this notice from this file!

GPO Jacket No. 560-102
Print Order 61540
Rise Business Services, LLC
Job=AZ15 7/11/2019



Box Number= AZ15155



Claim Begin-End: AMC452356-AMC452356

1 Initial Receipt



AZ15155-3

AMC452349-AMC452348

United States Department of the Interior
Bureau of Land Management
 DIV OF LANDS, MINRLS & ENERGY
 ONE N CENTRAL AVE
 PHOENIX, AZ 85004 -4427
 Phone: 602-417-9200

Receipt

No: 4295003

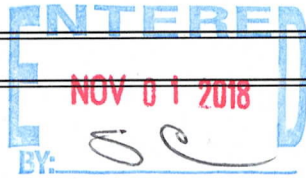
Transaction #: 4411144	
Date of Transaction: 10/30/2018	
CUSTOMER:	
EDWARD BANDYK 16449 N KIM DR FOUNTAIN HILLS,AZ 85268-1546 US	

LINE #	QTY	DESCRIPTION	REMARKS	UNIT PRICE	TOTAL
1	1.00	LOCATABLE MINERALS / MINING CLAIMS-NEW,UNADJUD, ONE OR MORE AUTH NOS / NEW MINING CLAIM PROCESSING FEE CASES: AMC452356/\$20.00		- n/a -	20.00
2	1.00	LOCATABLE MINERALS / MINING CLAIMS-NEW,UNADJUD, ONE OR MORE AUTH NOS / NEW MINING CLAIMS LOCATION FEE CASES: AMC452356/\$37.00		- n/a -	37.00
3	1.00	LOCATABLE MINERALS / MINING CLAIMS-NEW,UNADJUD, ONE OR MORE AUTH NOS / NEW MINING CLAIMS MAINTENANCE FEE CASES: AMC452356/\$155.00		- n/a -	155.00
TOTAL:					\$212.00

PAYMENT INFORMATION			
NOTE: Items will appear on credit card statement as "Bureau of Land Mgmt CO".			
1	AMOUNT:	212.00	POSTMARKED: N/A
	TYPE:	CREDIT CARD	RECEIVED: 10/30/2018
	NAME:	BANDYK, EDWARD 16449 N KIM DR FOUNTAIN HILLS AZ 85268-1546 US	
	CARD NO:	XXXXXXXXXXXX5356	AUTH CODE: 020215
	NAME ON CARD:	EDWARD J BANDYK	
	SIGNATURE:		

NOTICE!!

These documents have been scanned!

Do not place un-scanned documents beneath this notice!

Do not remove this notice from this file!

GPO Jacket No. 560-102
Print Order 61540
Rise Business Services, LLC
Job=AZ15 7/11/2019



Box Number= AZ15155



Claim Begin-End: AMC452356-AMC452356

2 Correspondence



AZ15155-3

AMC452349-AMC452348

**NO
DOCUMENTS
FOUND**

NO DOCUMENTS FOUND
NO DOCUMENTS FOUND

NOTICE!!

These documents have been scanned!

Do not place un-scanned documents beneath this notice!

Do not remove this notice from this file!

GPO Jacket No. 560-102
Print Order 61540
Rise Business Services, LLC
Job=AZ15 7/11/2019



Box Number= AZ15155



Claim Begin-End: AMC452356-AMC452356

3 Transfers



AZ15155-3

AMC452349-AMC452348

**NO
DOCUMENTS
FOUND**

NO DOCUMENTS FOUND
NO DOCUMENTS FOUND

NOTICE!!

These documents have been scanned!

Do not place un-scanned documents beneath this notice!

Do not remove this notice from this file!

GPO Jacket No. 560-102
Print Order 61540
Rise Business Services, LLC
Job=AZ15 7/11/2019



Box Number= AZ15155



Claim Begin-End: AMC452356-AMC452356

4 Annual Filings



AZ15155-3

AMC452349-AMC452348

**NO
DOCUMENTS
FOUND**

NO DOCUMENTS FOUND
NO DOCUMENTS FOUND

NOTICE!!

These documents have been scanned!

Do not place un-scanned documents beneath this notice!

Do not remove this notice from this file!

GPO Jacket No. 560-102
Print Order 61540
Rise Business Services, LLC
Job=AZ15 7/11/2019



Box Number= AZ15155



Claim Begin-End: AMC452356-AMC452356

5 Miscellaneous



AZ15155-3

AMC452349-AMC452348

**NO
DOCUMENTS
FOUND**

NO DOCUMENTS FOUND
NO DOCUMENTS FOUND

NOTICE!!

These documents have been scanned!

Do not place un-scanned documents beneath this notice!

Do not remove this notice from this file!

GPO Jacket No. 560-102
Print Order 61540
Rise Business Services, LLC
Job=AZ15 7/11/2019



Box Number= AZ15155



Claim Begin-End: AMC452356-AMC452356

6 Location Notices-Amendments and Supporting Documents



AZ15155-3

AMC452349-AMC452348

MINING CLAIM STATUS REPORT

Data Entered: 11/04 2018

MTP Checked By: [Signature]
GEO Checked By: [Signature]

LEAD SERIAL NUMBER: AMC 452354 thru AMC _____

NUMBER OF CLAIMS & TYPE:

- 1 LODE
- PLACER
- ASSOCIATION PLACER
- MILL SITE
- TUNNEL SITE

CHARGES:

Processing Fee @ \$20 = \$ 20

Location Fee @ \$37 = \$ 37

Maintenance Fee @ \$155 = \$ 155

Add'l Maint Fee for Assoc Placer = \$ _____

SUBTOTAL \$ _____

Other Fees \$ _____

Other Fees \$ _____

TOTAL \$ 212

TOTAL ACREAGE: _____ Per Claim
(Placer Only)

NUMBER OF LOCATORS: _____

DOCUMENTS RECEIVED VIA: Over-the-Counter Mail TIMELY FILED: Yes No

LEGAL DESCRIPTION: T 9N R 2E SEC 17

T _____ R _____ SEC _____

T _____ R _____ SEC _____

T _____ R _____ SEC _____

T _____ R _____ SEC _____

BLM FOREST SERVICE SUBJ TO PL 359: Yes No
WILDERNESS AREA

SPLIT ESTATE: N/A SX PX OTHER
SRHA Was proper Notice filed if located on SHRA Land? Yes No

RECONVEYED MINERALS ON BLM LAND REQUIRE OPENING ORDER FROM 1944 TO 1993:

Open to Entry On _____ N/A

COMMENTS/STATUS: VOID PARTIALLY VOID PVT MINERALS WITHDRAWN LANDS
OTHER

AMC452354

Claimant acknowledges that portions of the following claim(s) site(s) may be void or voidable.

Printed Name of Claimant _____ Signature of Claimant _____

*****FINAL ADJUDICATION*****

DATE _____ INITIALS _____

COPY

Edward J. Bandyk
16449 N. Kim Dr.
Fountain Hills, AZ, 85268

LOCATION NOTICE FOR PLACER MINING CLAIM

Amendment BLM Serial # _____

NOTICE IS HEREBY GIVEN that the #9

_____ placer mining claim has been located by

Edward J. Bandyk whose current mailing

address is 16449 N. Kim Dr.

Fountain Hills, AZ, 85268

The general course of this claim is North to South and it is situated in Yavapai

County, Arizona. This claim is 1320 feet in length and 660 feet in width.

20 Total Claim Acreage. This claim runs from the location monument on which this location notice is

posted at the NE corner of the claim approximately 1320 feet in a South direction to the

South end line and 660 feet in a West direction to the West end line. This claim is

marked by four monuments, one at each corner of the claim.

The location monument on which this notice is posted is situated within Section 17, Township

9 N, Range 2 E, Gila Salt River Base and Meridian, Arizona. This claim encompasses

portions of the following legal subdivision(s) if located by legal subdivision or the following quarter section(s),

section(s), Township(s) and Range(s) E2, NW4, NE4, Sec 17

T. 9N, R. 2E, Gila Salt River Base and Meridian, Arizona.

The locality of this claim with reference to some natural object or permanent monument and additional information

(if any) concerning its locality are as follows: NE Corner is 660 Feet

West of the N. West Corner of Sec. 17 T. 9N, R. 2E,

_____ The above information is shown on the attached map.

DATED AND POSTED on the ground this 23 day of September, 20 18.

LOCATOR(s) AGENT

Print Name(s) Edward J. Bandyk

Signature(s) Edward J. Bandyk

Form MCF102
Revised July 2014

RECEIVED
BLM AZ STATE OFFICE
2018 OCT 30 A 11:58
PHOENIX, ARIZONA

BLM
Date
Stamp

AMC152356

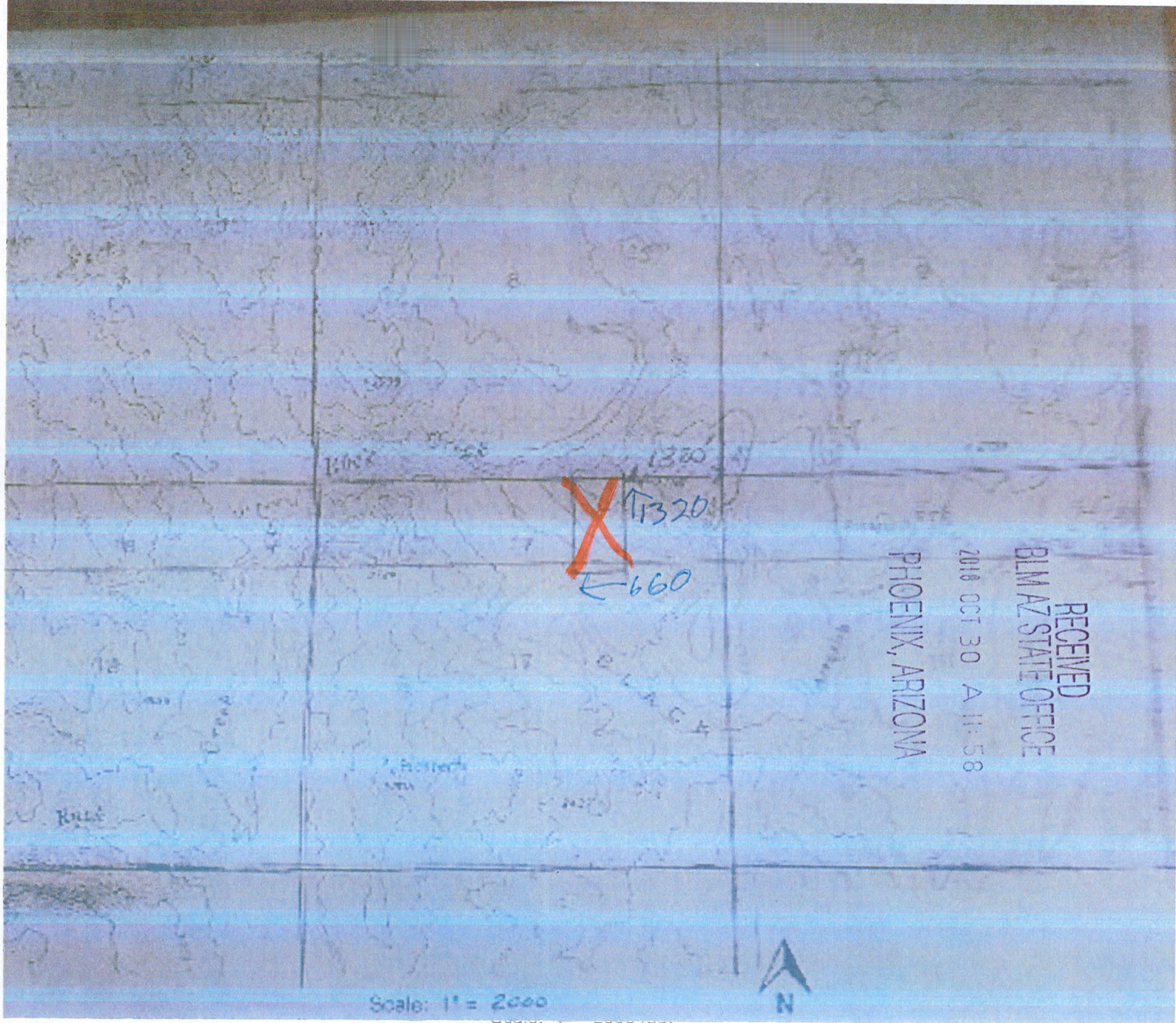

1. The above map depicts the Gold Rush #9 mining claim, which is located in Section (s) 8+17, Township 9 N, Range 2 E, Gila and Salt River Base and Meridian, Yavapai County, Arizona. Total claim acreage is 20 Acres
2. The type of corner and location monuments used are as follows: 2"x2" wood post Painted Red+White
3. The bearings and distances in degrees and feet between claim corners and to a public land survey monument are as depicted on the map.
4. If the claim is a placer or millsite claim with exterior limits conforming to legal subdivisions of the public survey, provide a legal description of the claim _____

AMC452356



LR2000 Internal

CR Geographic Report with Land

[Download User Guide \(pdf\)](#)

Purpose: This report produces a geographic listing of case information based on retrieval by Meridian/Township/Range. This report format will display the case type, case disposition, meridian, township, range, section, survey type, survey number, surface management agency, pending actions, serial number, and total case acres.



No Results

The specified criteria didn't result in any data. This is often caused by applying filters and/or selection steps that are too restrictive or that contain incorrect values. Please check your analysis filters and selection steps, and try again. The filters or selection steps currently being applied are shown below.

Filters

Disposition is equal to **AUTHORIZED, CANCELLED, EXPIRED, PENDING, REJECTED, RELINQUISHED, WITHDRAWN**
and Meridian Township Range Section is equal to **14 0090N 0020E 017 NE**
and Admin State is equal to **AZ**

[Return](#) - Refresh

